

K. S. SCHOOL OF ENGINEERING AND MANAGEMENT

LAYOUT PLAN OF 'B' BLOCK BASEMENT- II (MECH)

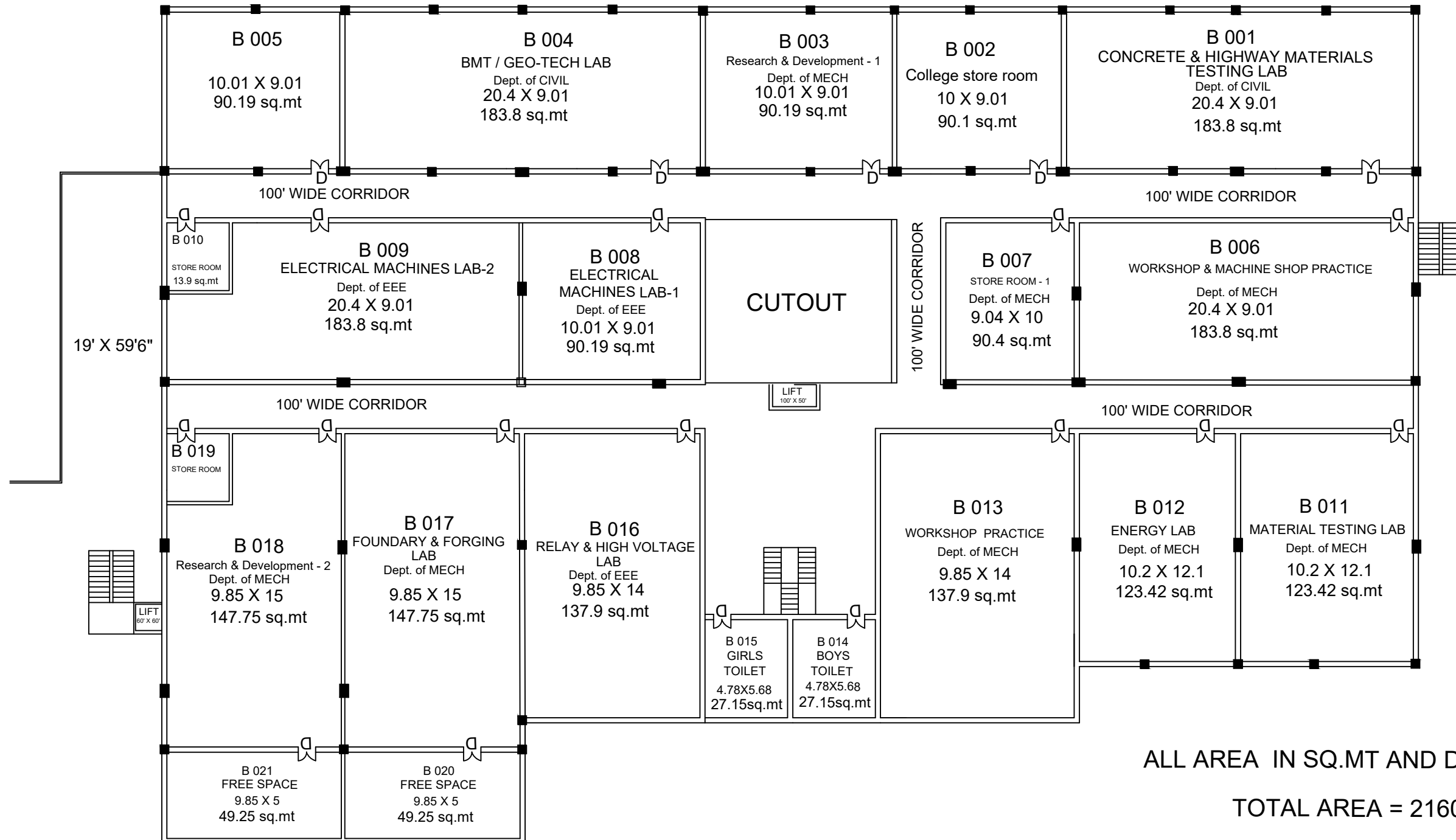

ALL AREA IN SQ.MT AND DIMENSIONS IN MTR
TOTAL AREA = 2160.53 SQ.MT

K. S. SCHOOL OF ENGINEERING AND MANAGEMENT

LAYOUT PLAN OF 'B' BLOCK BASEMENT- I (MECH)

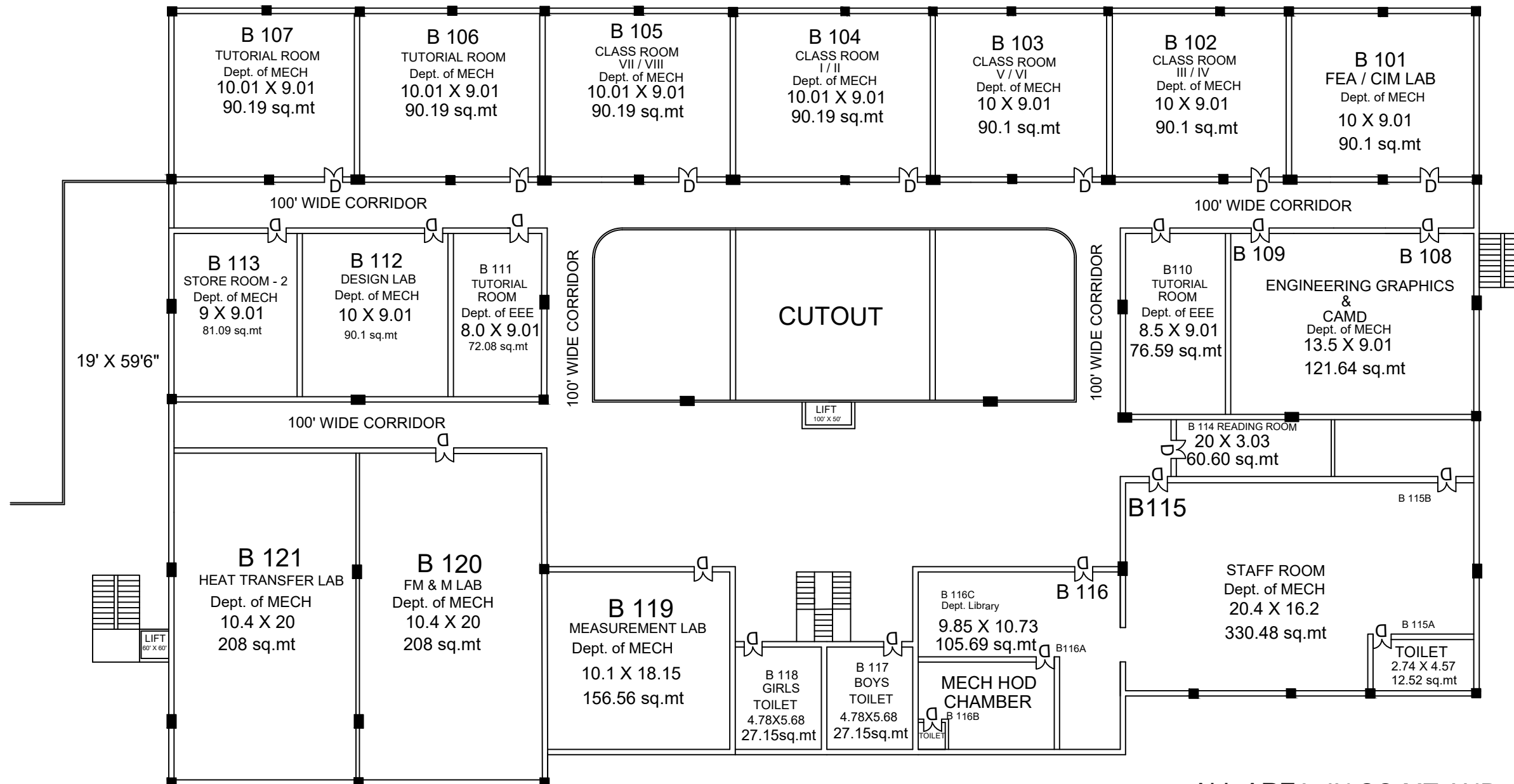

ALL AREA IN SQ.MT AND DIMENSIONS IN MTR

TOTAL AREA = 1838.93 SQ.MT

K. S. SCHOOL OF ENGINEERING AND MANAGEMENT LAYOUT PLAN OF 'B' BLOCK GROUND FLOOR (EEE)

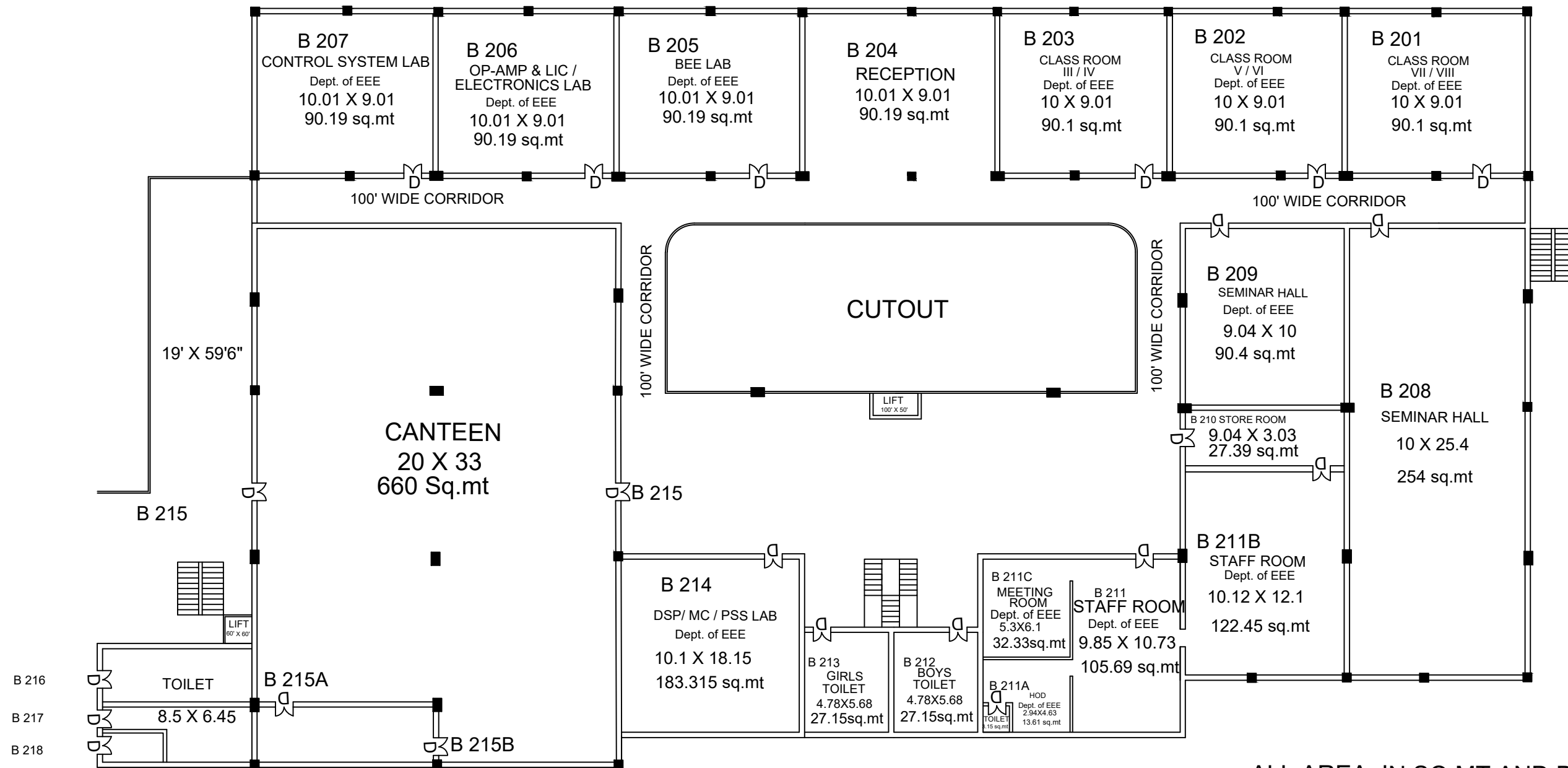

ALL AREA IN SQ.MT AND DIMENSIONS IN MTR

TOTAL AREA = 2058.98 SQ.MT

K. S. SCHOOL OF ENGINEERING AND MANAGEMENT

LAYOUT PLAN OF 'B' BLOCK FIRST FLOOR (CIVIL)

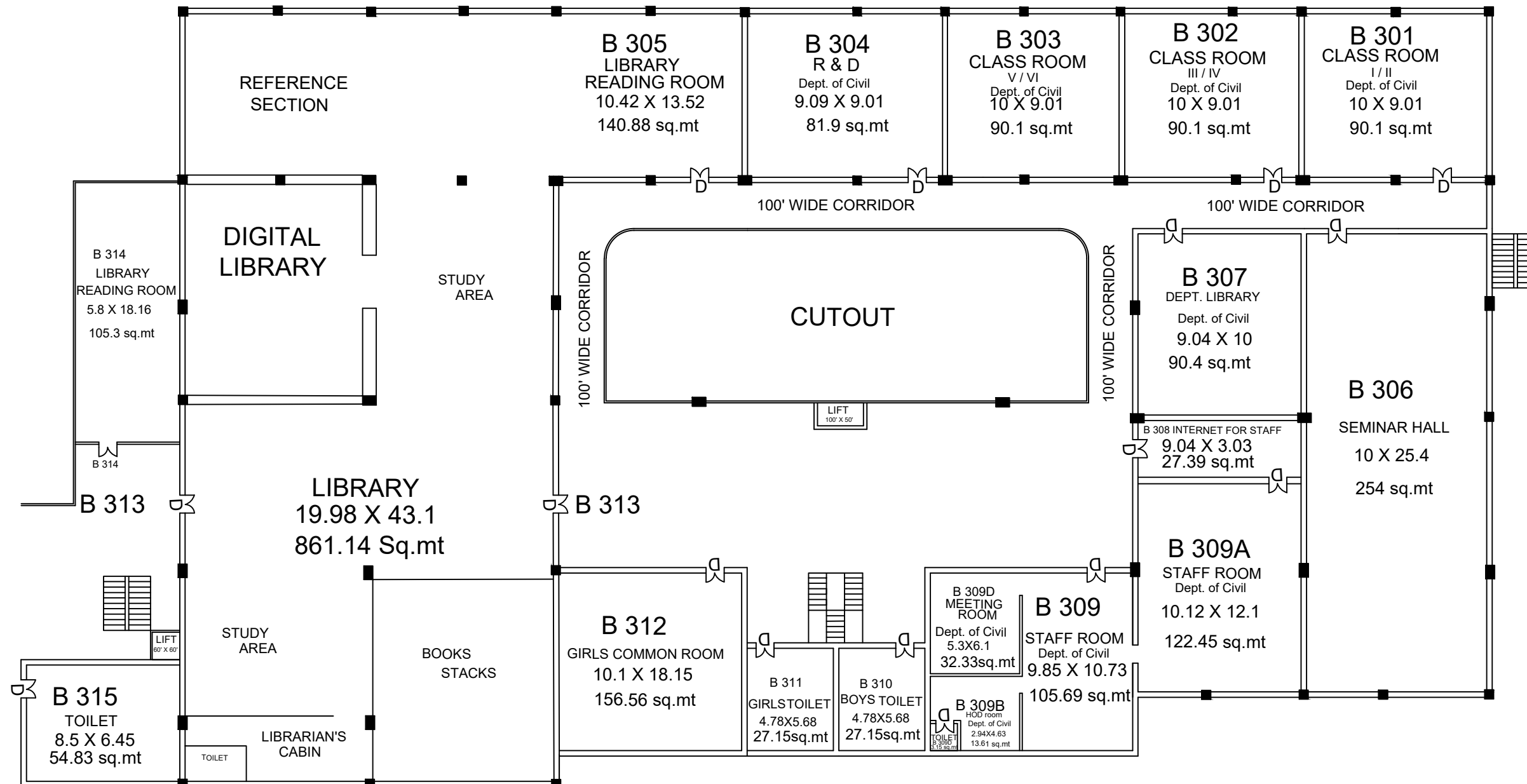

ALL AREA IN SQ.MT AND DIMENSIONS IN MTR

TOTAL AREA = 2124.43 SQ.MT

K. S. SCHOOL OF ENGINEERING AND MANAGEMENT LAYOUT PLAN OF 'B' BLOCK SECOND FLOOR (CIVIL)

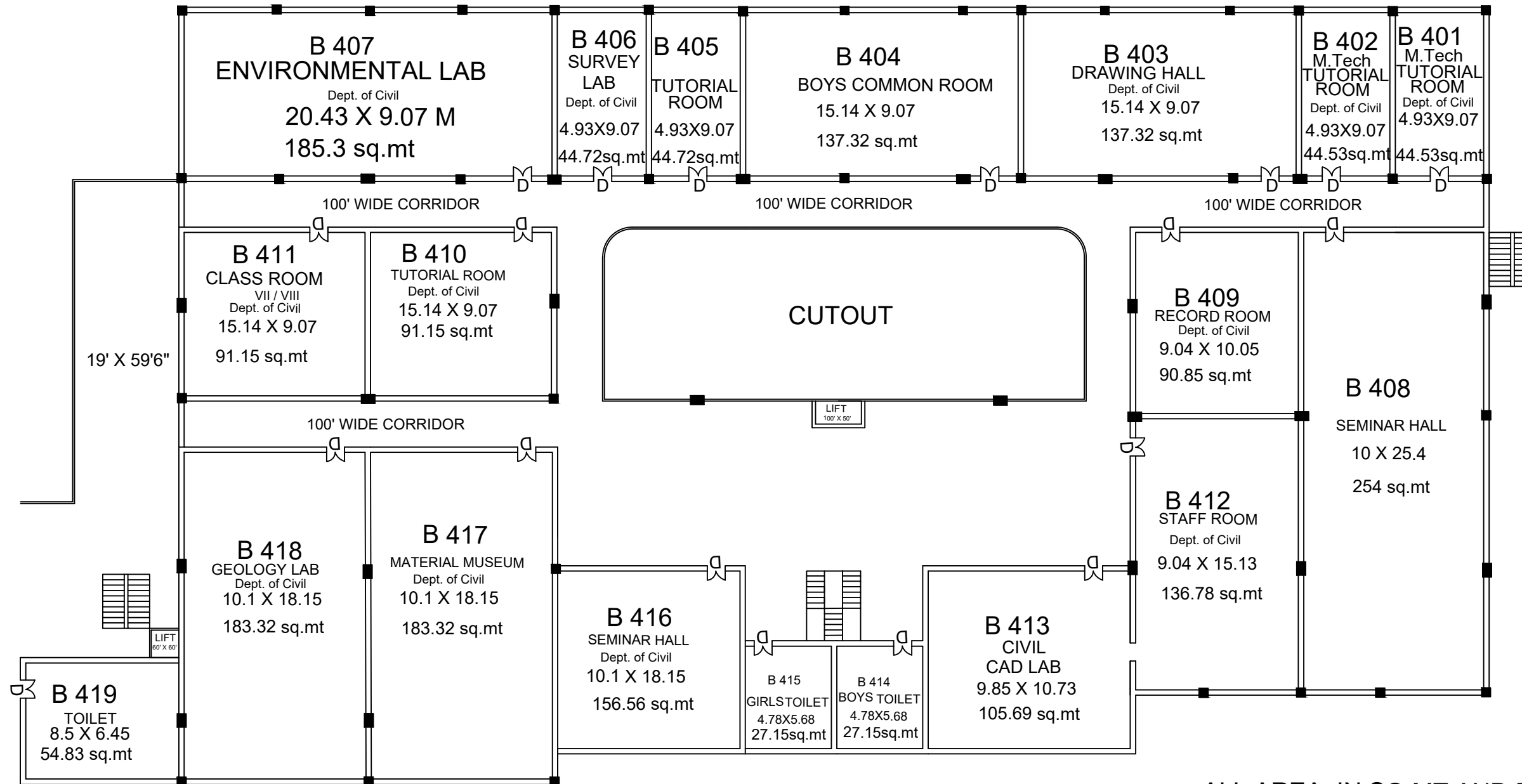

ALL AREA IN SQ.MT AND DIMENSIONS IN MTR

TOTAL AREA = 1969.69 SQ.MT